

GENERAL NOTES:

- 1.) SIZE AS SHOWN
- 2.) GLASS TO BE 1/2" TEMPERED (SPECIFY TINT)

REV	DESCRIPTION	BY	DATE	CHKD
.

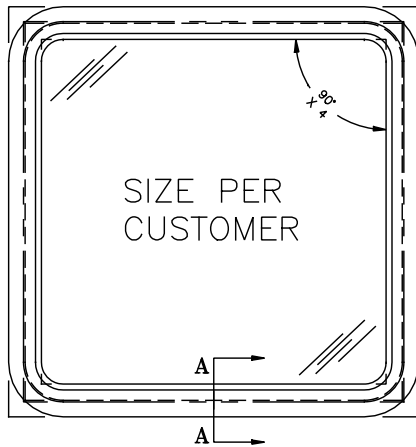

ELEVATION

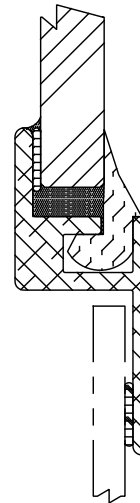

SECTION A-A

IMPORTANT! THIS DRAWING SUPERSEDES ALL OTHER DOCUMENTS
 By signing this approval you accept the dimensions and details shown here are correct to fit your application regardless of any differences between this drawing and any contract specifications. Should you have any questions or see any errors DO NOT SIGN THIS APPROVAL until the drawing is corrected accordingly.

CUSTOMER APPROVAL

BY: _____

DATE: _____

APPROX. WEIGHT:	_____
PAINT/FINISH:	_____
CUSTOMER:	_____
HULL NO./PROJECT	_____
P.O. NO.	S.O. NO.
ITEM NO.	_____
BASE MODEL:	WIN-1004-500-B

PACIFIC COAST MARINE
 MEMBER OF ADVANCED MARINE TECHNOLOGIES
 6000 23rd DRIVE WEST
 EVERETT, WASHINGTON 98203 USA
 WWW.PCMIL.COM

POS	QTY	DESCRIPTION	MATERIAL	PART NUMBER
01	REQ.	MAIN FRAME	6063 ALU.	00000010145
02	REQ.	FULCRUM RUBBER	RUBBER	00000014723
03	REQ.	BEDDING TAPE	BUTYL	00000014675
04	REQ.	TOE BEAD	URETHANE	00000014682
05	REQ.	SEALANT	URETHANE	00000014703
06	REQ.	GLAZING (SEE G.N. 2)	GLASS	000000XXXXX

TITLE: WIN-1004-FX FIXED WINDOW		
DATE: 00/00/00	DRAWING NO: 000000XXXXX	REV. ---
DRAWN BY: ---	CHECKED BY: ---	SHEET: 01 OF 01